

<b>SPECIFICATION SHEET NO.</b>	S0510 – BAV19W0000S0A8	
<b>ORIGINAL MFG/PART NO.</b>	MDD Diodes/BAV19W	
<b>NEXTGEN PART CODE</b>	BAV19W0000S0A8	Indicate This Code For <a href="#">RFQ</a> /Order
<b>DATE</b>	May. 10, 2025	
<b>REVISION</b>	A3	Updated With Most Recent Data
<b>DESCRIPTION AND MAIN PARAMETRICS</b>	<p>SMD Fast Switching Diodes, Case SOD-123 BAV Series, 2 Pads</p> <p>Working Peak Reverse Voltage (VRWM): 120V Max.</p> <p>Forward Continuous Current (IFM): 0.25A Max.</p> <p>Operation Junction Temperature Range (TJ): -55°C ~+150°C</p> <p>Package in Tape/Reel, 3000pcs/Reel</p> <p>RoHS/RoHS III compliant, RoHS Annex III lead Exemption (Exempt per RoHS EU 2015/863) and Halogen Free (HF)</p>	
<b>CUSTOMER</b>		
<b>CUSTOMER PART NUMBER</b>		
<b>CROSS REF. PART NUMBER</b>		
<b>MEMO</b>		

<b>VENDOR APPROVE</b>
<div> <div>Issued/Checked/Approved</div> <div>    </div> </div>
Effective Date: May. 10, 2025

<b>CUSTOMER APPROVE</b>
Date:

## MAIN FEATURE

- Fast Switching Speed
- Case Type SOD-123
- Surface Mount Package Ideally Suited For Automatic Insertion
- High Conductance
- Meet MSL 1 Requirement
- Cross Competitors Parts and More.
- RoHS/RoHS III compliant, RoHS Annex III lead Exemption (Exempt per RoHS EU 2015/863) and Halogen Free (HF)



*Image shown is a representation only. Exact specifications should be obtained from the product dimension.*

## APPLICATION

- For General Purpose Switching Applications

## ELECTRICAL CHARACTERISTICS

- See Page 5 ~ Page 6.
- All Products Parameters are Subject To NextGen Components' Final Confirmation.



## HOW TO ORDER

- Please Follow Up Part Code Guide And Indicate NextGen Part Code BAV19W0000S0A8 For RFQ and Order.

## PART CODE GUIDE

**RFQ**

[Request For Quotation](#)

CODE	NAME	KEY SPECIFICATION OPTION
BAV	Product Series Code	SMD Fast Switching Diodes, 2 Pads
19W	Parameters Code	Letter or Digits (A~Z, a~z or 0~9)
0000S0	Internal Control Code	Letter or Digits (A~Z, a~z or 0~9)
A8	Marking Code	Marking "A8"
XX	Special/Custom Parameters Code	Letter or Digits (A~Z, a~z or 0~9) for Special Parametric; Blank: N/A



Recommend Pad Layout - Tolerance:  $\pm 0.05\text{mm}$

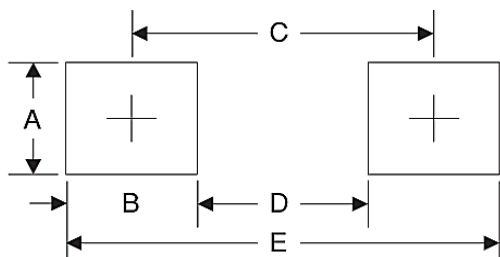

SYMBOL	UNIT (INCH)	UNIT (MM)
A	0.047	1.2
B	0.047	1.2
C	0.126	3.2
D	0.079	2.0
E	0.173	4.4

## MECHANICAL CHARACTERISTICS

CASE	FLAMMABILITY RATING	TERMINALS	MARKING
JEDEC SOD-123 molded plastic body	UL 94V-0	Solder plated, solderable per MIL-STD-750, Method 2026	A8

## ABSOLUTE MAX. RATING - $T_A=25^{\circ}\text{C}$ unless otherwise specified, For Reference Only

PARAMETER		SYMBOLS	VALUE	UNITS
Forward Continuous Current		$I_{FM}$	250	mA
Average Rectified Output Current		$I_O$	200	mA
Peak Forward Surge Current	@ = 1.0s	$I_{FSM}$	1.0	A
	@ = 1.0ms		3.0	
	@ = 1.0us		9.0	
Repetitive Peak Forward Current		$I_{FRM}$	625	mA
Power Dissipation		$P_d$	500	mW
Thermal Resistance Junction To Ambient		$R_{\theta JA}$	500	K/W
Operation Junction and Storage Temp. Range		$T_J, T_{STG}$	-55 ~+ 150	$^{\circ}\text{C}$

**ABSOLUTE MAXIMUM RATINGS** –For Different Part Code  $T_A=25^{\circ}\text{C}$  unless otherwise specified

PART CODE	PEAK REPETITIVE PEAK REVERSE VOLTAGE	WORKING PEAK REVERSE VOLTAGE	DC BLOCKING VOLTAGE	RMS REVERSE VOLTAGE	NON-REPETITIVE PEAK REVERSE VOLTAGE	MARKING LIST
	VRRM	VRWM	VR	VR(RMS)	VRM	
	V	V	V	V	V	
BAV19W0000S0A8	120	120	120	71	120	A8
BAV20W0000S0T2	200	200	200	106	200	T2
BAV21W0000S0T3	250	250	250	141	250	T3

**CHARACTERISTICS**–  $T_A=25^{\circ}\text{C}$  unless otherwise specified, For Reference Only

PARAMETER		SYMBOLS	VALUE	UNITS
Forward Voltage	$I_F=0.1\text{A}$	$V_{F1}$	1.0	V
	$I_F=0.2\text{A}$	$V_{F2}$	1.25	
Reverse Current	$V_R=120\text{V}$	$I_R$	0.1	$\mu\text{A}$
Capacitance Between Terminals	$V_R=4\text{V}, f=1.0\text{MHz}$	$C_T$	5	pF
Reverse Recovery Time	$I_F=I_R=10\text{mA}$ $I_{rr}=0.1 \times I_R, R_L=100\Omega$	$t_{rr}$	50	ns

**RATINGS AND CHARACTERISTICS CURVES-** For Reference Only,  $T_a=25^{\circ}\text{C}$  Unless Otherwise Specified.

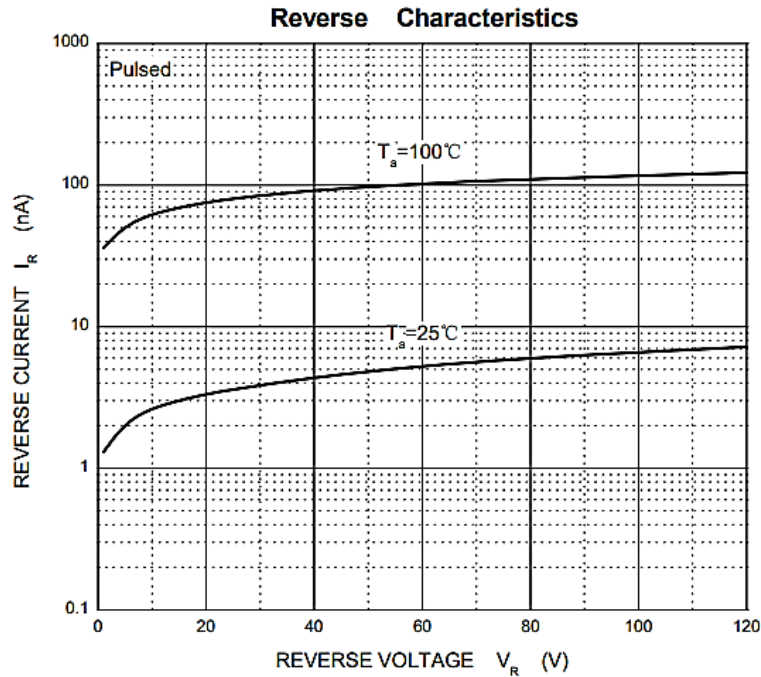
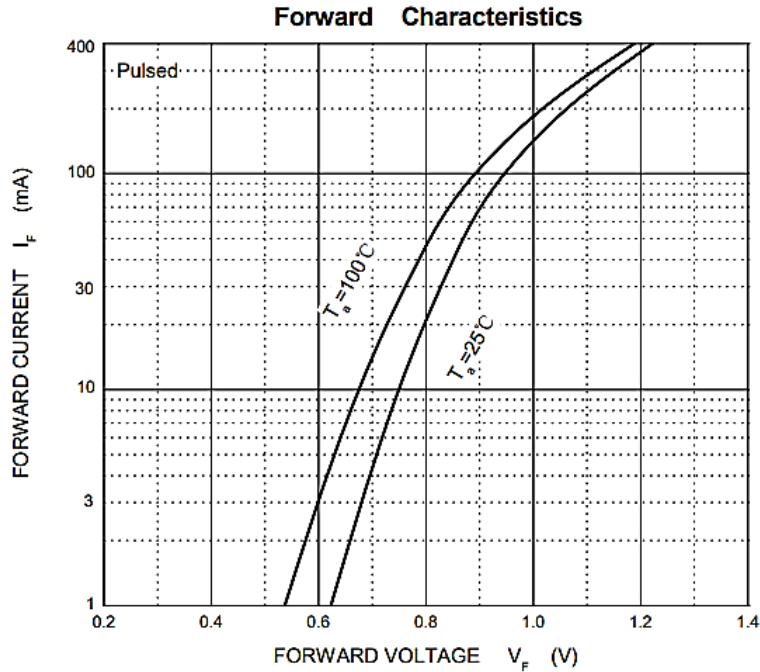

**RATINGS AND CHARACTERISTICS CURVES**- For Reference Only,  $T_a=25^{\circ}\text{C}$  Unless Otherwise Specified.

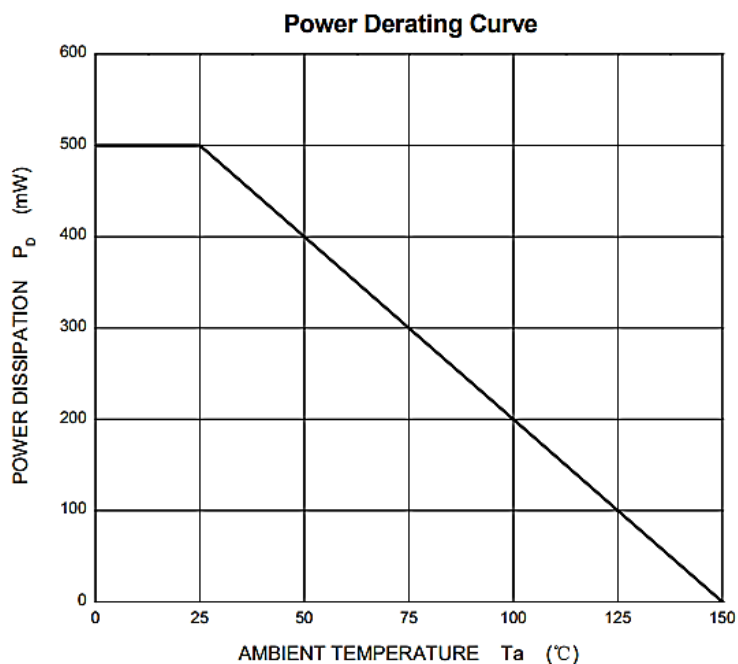
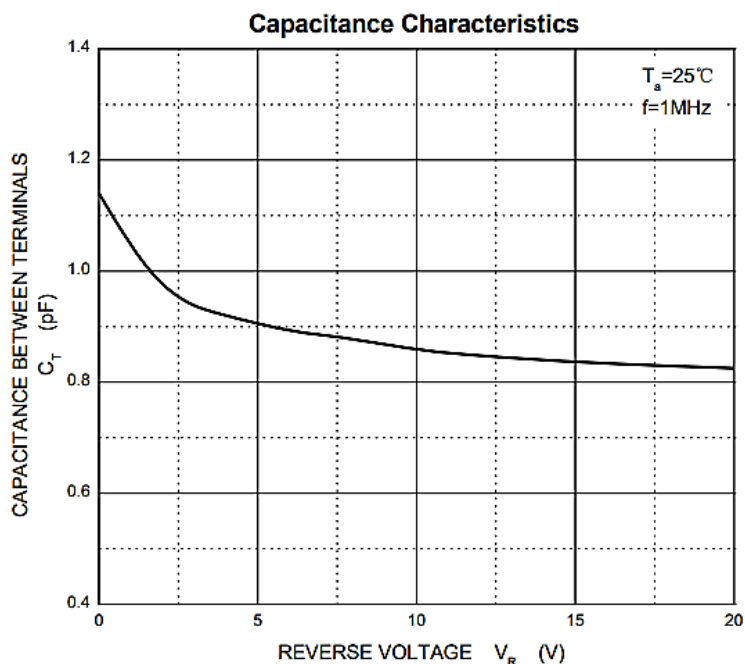

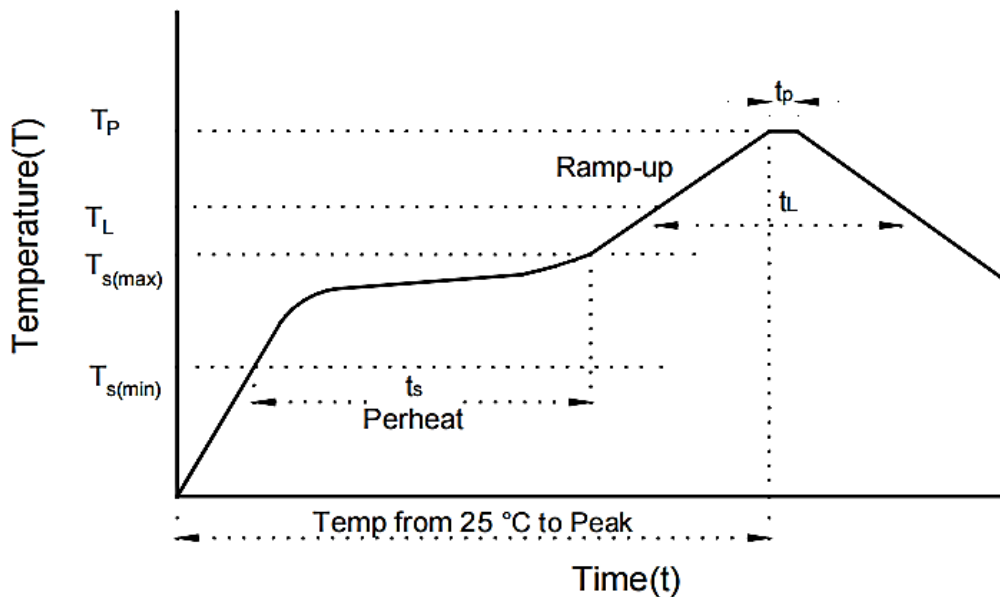

**SUGGESTED REFLOW PROFILE - For Reference Only**

PROFILE FEATURE		PB-FREE ASSEMBLY
Average Ramp-up Rate ( $T_L$ Max to $T_p$ )		3°C/second Max
Preheat	Temperature Min ( $T_s$ Min.)	150°C
	Temperature Max ( $T_s$ Max.)	200°C
	Time ( $t_s$ Min. to $t_s$ Max.)	60 ~ 180 seconds
Time maintained above	Temperature ( $T_L$ )	217°C
	Time ( $t_L$ )	60 ~ 150 seconds
Peak/Classification Temperature ( $T_p$ )		260 °C
Time within 5°C of actual Peak Temperature ( $t_p$ )		10 seconds Max.
Ramp-down Rate		6 °C /Second Max.
Time 25 °C to Peak Temperature		8 Minutes Max.
Suggest reflow times		3 Times Max.

**TAPE/REEL** - Unit: mm, All Devices are packed in accordance with EIA standard RS-481-A and specifications

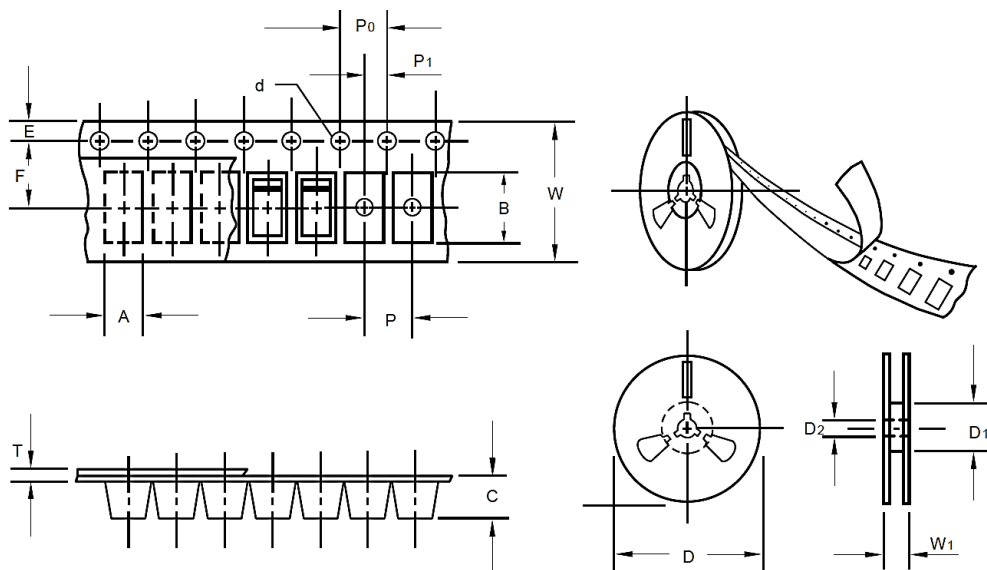

ITEM	SYMBOL	TOLERANCE	SOD-123
Carrier width	A	0.1	2.10
Carrier Length	B	0.1	4.00
Carrier Depth	C	0.1	1.60
Sprocket hole	d	0.05	1.55
7"Reel outside diameter	D	2	178
7"Reel inner diameter	D1	Min.	50
Feed hole diameter	D2	0.5	13
Sprocket hole position	E	0.1	1.75
Punch hole position	F	0.1	3.5
Punch hole pitch	P	0.1	4
Sprocket hole pitch	P0	0.1	4
Embossment center	P1	0.1	2
Overall tape thickness	T	0.1	0.25
Tape width	W	0.3	8.15
Reel width	W1	1	10.50
Qty. Per Reel (pcs)	3000		

## IMPORTANT NOTES AND DISCLAIMER

1. **ROHS COMPLIANCE:** The levels of RoHS restricted materials in this product are below the maximum concentration values (also referred to as the threshold limits) permitted for such substances, or are used in an exempted application, in accordance with EU RoHS Directive (EU) 2015/863 EC (RoHS3). RoHS Test Report for this product can be obtained at Download Center.
2. **REACH COMPLIANCE:** REACH substances of high concern (SVHCs) information is available for this product. Since the European Chemical Agency (ECHA) has published notice of their intent to frequently revise the SVHC listing for the foreseeable future, REACH Test Report for this product can be obtained at Download Center.
3. All Product parametric performance is indicated in the Electrical Characteristics for the listed herein test conditions, unless otherwise noted. Product performance may not be indicated by the Electrical Characteristics if operated under different conditions.
4. NextGen Component, Inc (*NextGen*) reserves the right to make changes to this document and its products and specifications at any time without notice. Customers should obtain and confirm the latest product information and specifications before final design, purchase or use.
5. *NextGen* makes no warranty, representation or guarantee regarding the suitability of its products for any particular purpose, nor does *NextGen* assume any liability for application assistance or customer product design.
6. *NextGen* does not warrant or accept any liability with products which are purchased or used for any unintended or unauthorized application. No license is granted by implication or otherwise under any intellectual property rights of NextGen.
7. *NextGen* products are not authorized for use as critical components in life support devices or systems without express written approval by *NextGen*.
8. *NextGen* requires that customers first obtain an RMA (Returned Merchandise Authorization) number prior to returning any products. Returns must be made within 30 days of the date of invoice, be in the original packaging, unused and like-new condition. At the time of quoting or purchasing, a product may say that it is Non-Cancelable/ Non-Returnable (NCNR). These products are not returnable and not refundable.